



Hardy plants for tough places

TRUE YORKSHIRE GRIT

West Yorkshire Group

The HARDY PLANT SOCIETY



THE EXHIBIT

To represent our Group's location and the versatility and tenacity of hardy perennials the title of our display is 'True Yorkshire Grit', suggesting toughness, hardness and resilience.

The West Yorkshire group meets in Leeds and this design, with strong horizontal and vertical lines, echoes the skyline, symbolising the regeneration of the city. The wide variety of plants displayed reflects this regeneration: hardy plants for tough places.

The York stone path through the plants has been cut from some old stone roofing slates from the former St Margaret of Antioch church building on Cardigan Road, Leeds 6.

The building was consecrated in 1909 and has a wonderful late Gothic revival interior and is a listed Grade II building. It is undergoing renovation as and Arts and Event Centre called Left Bank Leeds and is expected to be fully operational this year. Some of the 100 year old stone roofing slates had to be replaced and we have been given use of a number of these.

As herbaceous perennials regenerate each year so the supporting structure of our display will be regenerated too. The Chelsea display will be recreated using

late summer perennials in September at the Harrogate Autumn Flower Show (dates to be included, website address) and after that the structure will go to Askham Bryan College, York where it will be replanted.

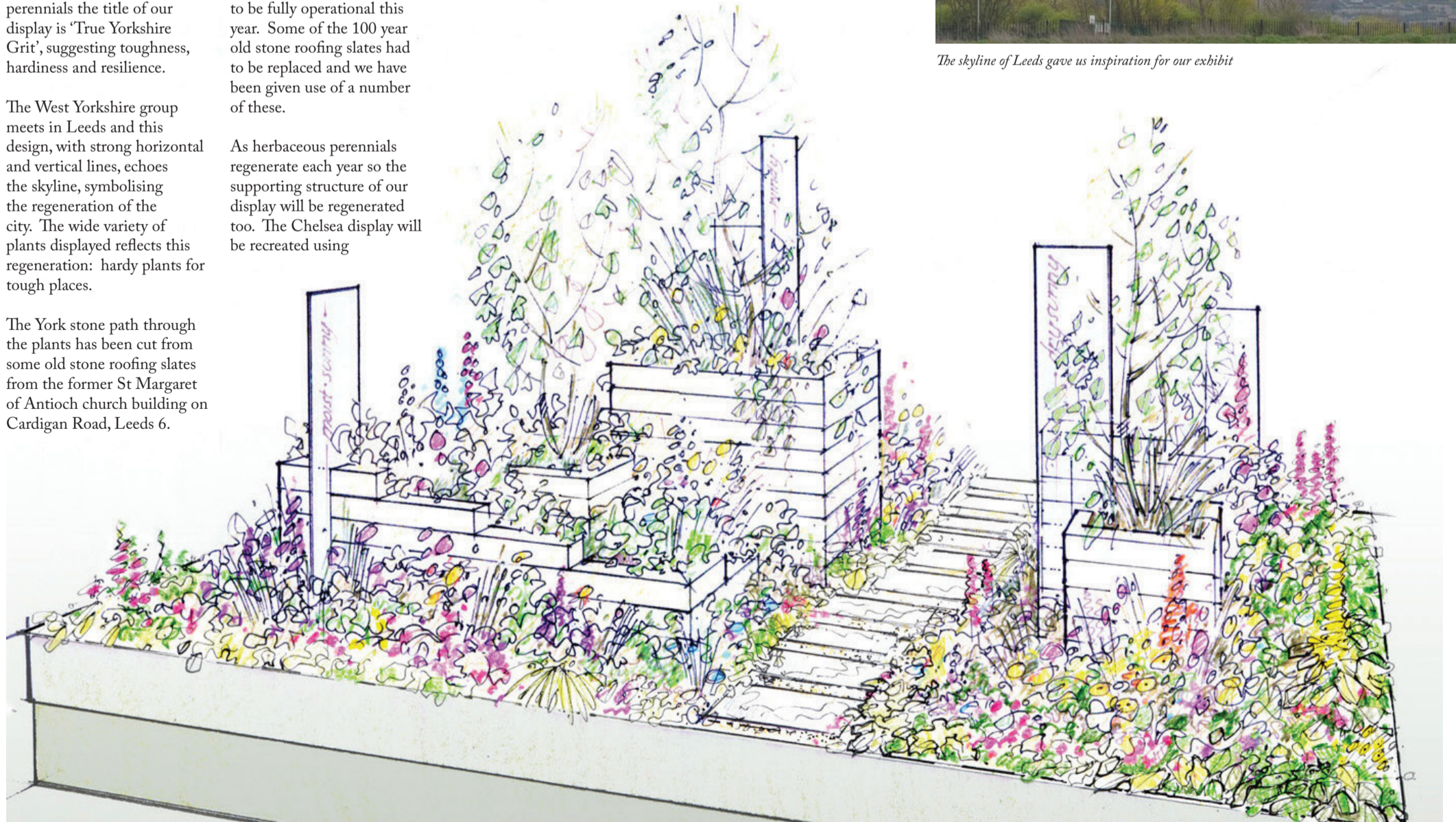

The skyline of Leeds gave us inspiration for our exhibit

ACKNOWLEDGEMENTS

- A huge thank you to all our members and friends for their unfailing support with fundraising through coffee mornings, raffles, plant sales and open gardens.
- Askham Bryan College (stand building)
 - Burton Agnes Hall, Driffield (sponsorship)
 - Colton Signs, Harrogate (Perspex panels)
 - David Smith (Trillium Gardens), Harrogate
 - Dove Cottage Nursery and Garden, Halifax (stand design)
 - EDC, Exhibition and Display Contracts Ltd, Harrogate (stand construction)
 - Great Dixter House and Gardens, Rye
 - Harold's Cottage Garden Plants, Hitchurch
 - Harrogate Borough Council
 - Howard Nurseries Ltd, Diss, Norfolk
 - Kirkstall Abbey, Leeds (fundraising)
 - Leeds City Council (sponsorship)
 - Left Bank Leeds (York stone)
 - Newby Hall, Ripon (leaflet sponsorship)
 - Paxton Horticultural Society, Leeds (fundraising)
 - Plant Heritage (fundraising)
 - Jo Pickering, Ridgfield Nursery, Knarsborough
 - Stockeld Park, Wetherby (fundraising)
 - Treasure Creative, Harrogate (leaflet design)
 - York Gate Garden, Leeds (fundraising)
 - Yorkshire Forward (sponsorship)

THE HARDY PLANT SOCIETY

The Hardy Plant Society exists to stimulate interest in growing hardy herbaceous plants. From the earliest days, the Hardy Plant Society has always been a friendly society and the range of activities offered locally and nationally gives members plenty of opportunity to meet other keen gardeners, sharing ideas and information in a convivial atmosphere. The activities and work of the Society inform and encourage the more gardener, stimulate and enlighten the novice knowledgeable, and entertain and enthuse all gardeners bonded by a love for, and an interest in, hardy perennial plants.

For further information about the Hardy Plant Society please contact:

Further information is available from:
Mrs Pam Adams, The Administrator,
The Hardy Plant Society,
Little Orchard,
Great Comberton,
Pershore,
Worcestershire
WR10 3DP.

Tel: 01386 710317 Fax: 01386 710117
Email: admin@hardy-plant.org.uk
www.hardy-plant.org.uk

The Hardy Plant Society was formed in 1957 by a group of eminent gardeners and nurserymen. It provides its many members, both in the UK and overseas, with information about familiar and less well known perennials, how to grow them and where they may be obtained.

THE PLANTS

Our stand is divided into distinct areas identified by panels adjacent to each. The areas represent different environments with planting which not only survives there but flourishes and regenerates each year. These areas are:

Hot, Dry & Stony

The combination of full sun and poor stony soil presents a challenge to the gardener. However, the plants shown here grow best in such conditions.

Damp & Shady

These plants need cool moisture retentive conditions to flourish and to reach their full potential.

Exposed & Windy

With a changing climate we are experiencing unseasonably strong winds. The plants in this area will thrive in these challenging conditions.

1 HOT, DRY & STONY

Acanthus dioscoridis var. perringii
 Allium atropurpureum
 Allium christophii
 Allium nigrum
 Allium schubertii
 Anthemis 'Susanna Mitchell'
 Artemisia schmidtiana 'Nana' AGM
 Artemisia stelleriana 'Boughton Silver'
 Asphodeline lutea
 Atriplex halimus
 Ballota pseudodictamnus AGM
 Bupleurum falcatum
 Ceanothus 'Concha' AGM
 Coronilla valentina subsp. glauca 'Citrina' AGM
 Echinops bannaticus 'Taplow Blue' AGM
 Erigeron karvinskianus AGM
 Eryngium bourgatii 'Picos Blue'
 Erysimum 'Constant Cheer'
 Euphorbia polychroma AGM
 Euphorbia characias 'Black Pearl'
 Euphorbia characias Silver Swan
 Euphorbia characias subsp. wulfenii 'Westacre Giant'
 Foeniculum vulgare 'Purpureum'
 Festuca glauca 'Blaufuchs' AGM
 Geranium palmatum AGM
 Gladiolus communis subsp. byzantinus AGM
 Gypsophila 'Rosenschleier' AGM
 Hebe hulkeana
 Helichrysum 'Schwefellicht'
 Iris 'Jane Phillips' AGM
 Iris 'Dutch Chocolate'

Linaria dalmatica
 Linaria purpurea 'Alba'
 Linum perenne
 Lotus hirsutus AGM
 Lupinus chamissonis
 Lychnis 'Hill Grounds'
 Nepeta racemosa 'Walker's Low'
 Onopordum nervosum AGM
 Origanum laevigatum 'Herrenhausen' AGM
 Othonno cheirifolia
 Ozothamnus selago
 Papaver rupifragrum 'Flore Pleno'
 Phlomis italica
 Phuopsis stylosa
 Phlox subulata 'McDaniel's Cushion'
 Potentilla megalantha AGM
 Rhodanthemum hosmariense AGM
 Salvia argentea AGM
 Salvia nemerosa 'Lubecca'
 Sedum 'Bertram Anderson' AGM
 Senecio polyodon
 Sisyrinchium striatum
 Stachys byzantine 'Silky Fleece'
 Stipa gigantea AGM
 Stipa tenuissima
 Trifolium repens 'Purpurascens'
 Tritelia laxa 'Koningin Fabiola'
 Verbascum 'Cotswold Beauty' AGM
 Verbascum 'Merlin'
 Verbascum chaixii Album AGM

2 DAMP & SHADY

Adiantum venustum AGM
 Athyrium niponicum var. pictum AGM
 Astilboidea tabularis
 Astrantia major subsp. involucrata 'Shaggy' AGM
 Betula nigra 'Heritage' AGM
 X Heucherella 'Dayglow Pink'
 Hemerocallis 'Golden Zebra'
 Hosta 'Gold Standard'
 Hosta 'June' AGM
 Hosta 'El Nino'
 Iris sibirica 'Imperial Velvet'
 Lamium maculatum 'White Nancy' AGM
 Lysimachia atropurpurea 'Beaujolais'

Lysimachia punctata 'Alexander'
 Monarda 'Gardenview Scarlet' AGM
 Persicaria bistorta 'Superba' AGM
 Persicaria microcephala 'Red Dragon'
 Polystichum munitum AGM
 Primula Harlow Carr hybrids
 Ranunculus aconitifolius 'Flore Plena' AGM
 Sanguisorba officinalis 'Arnhem'
 Semiaquilegia 'Sugar Plum Fairy'
 Spartina pectinata 'Aureomarginata'
 Trautvettaia carolinensis var. japonica
 Veronica gentianoides AGM

3 EXPOSED & WINDY

Acanthus spinosus AGM
 Allium roseum
 Achillea 'Credo' AGN
 Achillea 'Moonshine' AGM
 Amsonia orientalis
 Anchusa azurea 'Opal'
 Artemisia 'Powis Castle' AGM
 Baptisia australis 'AGM'
 Betula utilis var. jacquemontii 'Snow Queen'
 Campanula glomerata 'Superba' AGM
 Campanula persicifolia 'Chettle Charm' AGM
 Celmisia spectabilis 'Eggleston Silver'
 Cirsium rivulare 'Atropurpureum'
 Clematis montana
 Cynoglossum nervosum
 Dictamnus albus var. purpureus AGM
 Eleagnus 'Quicksilver' AGM
 Galega orientalis

Geranium pyrenaicum 'Bill Wallis'
 Geranium x riversleianum 'Russell Prichard' AGM
 Geranium subcaulescens 'Splendens' AGM
 Geum 'Red Wings'
 Helictotrichon sempervirens AGM
 Heuchera 'Peach Flambe'
 Heuchera 'Plum Royale'
 Heuchera 'Sugar Frosting'
 Libertia grandiflora AGM
 Libertia ixioidea 'Goldfinger'
 Lychnis coronaria 'Gardeners' World'
 Nepeta x faassenii 'Kit Cat'
 Ophiopogon planiscapus 'Nigrescens' AGM
 Phlomis tuberosa 'Bronze Flamingo'
 Physocarpus opulifolius 'Diabolo' AGM
 Salvia officinalis 'Purpurascens' AGM

Galega orientalis

Wet & Boggy

Recent spells of heavy, prolonged rain is creating areas of waterlogged ground in many gardens. The plants growing here will not be adversely affected by short periods of flooding.

Dry & Shady

When established these plants grow well with little direct sun and are not affected by fierce competition for available water.

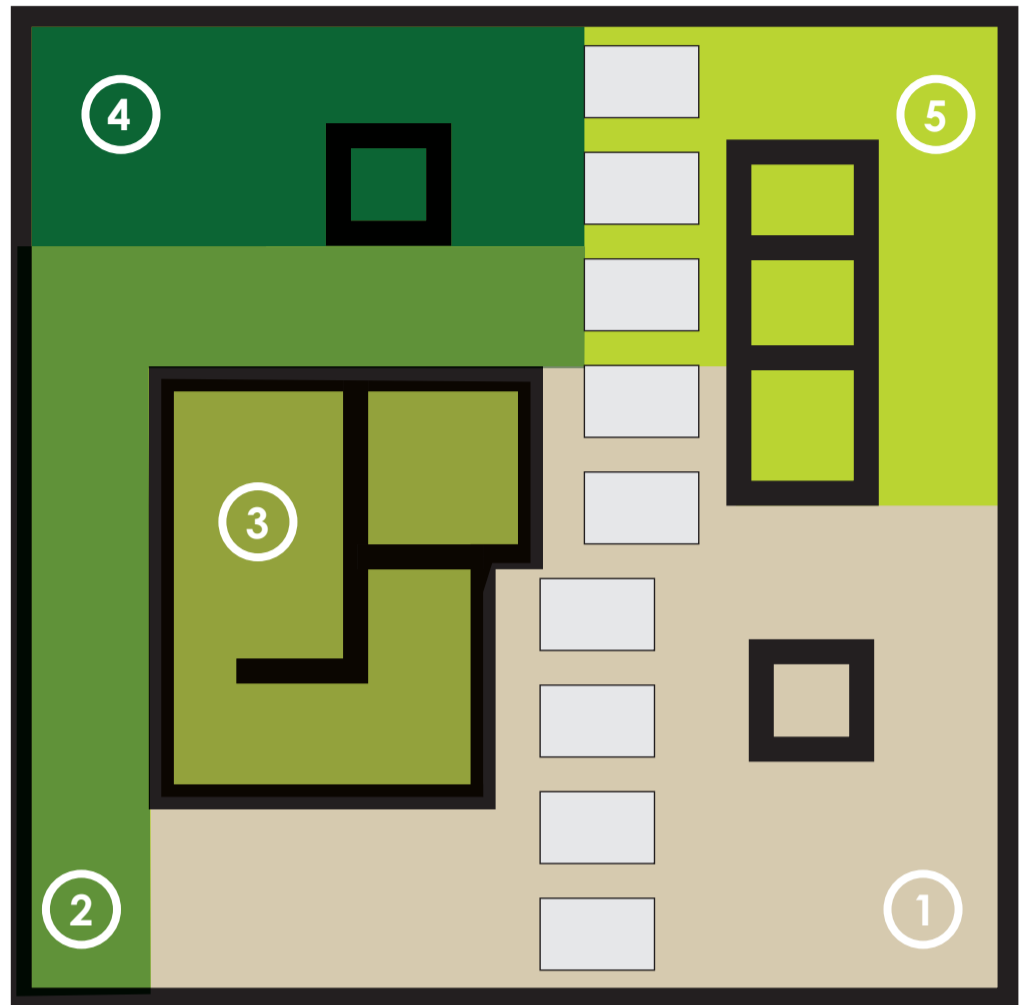

Please note that due to the prolonged severe winter and late spring it may have been necessary to make last minute alterations to the plants in our exhibit. Replacements have been chosen with care to reflect the theme of hardy plants for tough places.

4 WET & BOGGY

Carex elata 'Aurea' AGM
 Chionochloa rubra
 Equisetum hyemale
 Euphorbia palustris AGM
 Glyceria maxima var. variegata
 Houttuynia cordata 'Joker's Gold'
 Iris ensata 'Rose Queen' AGM
 Iris ensata 'Hougyoku'
 Iris pseudacorus 'Variegata' AGM
 Iris sibirica 'Imperial Velvet'
 Juncus patens 'Carman's Grey'
 Lysimachia punctata 'Alexander'

Lythrum salicaria 'Blush'
 Mimulus cardinalis AGM
 Osmunda regalis AGM
 Persicaria bistorta 'Superba' AGM
 Phyllostachys nigra AGM
 Primula prolifera AGM
 Ranunculus acris 'Flore Pleno' AGM
 Rodgersia 'Irish Bronze' AGM
 Salix exigua
 Scrophularia auriculata 'Variegata'
 Spartina pectinata 'Aureomarginata'

5 DRY & SHADY

Acanthus spinosus AGM
 Anthriscus sylvestris 'Ravenswing'
 Aquilegia chrysantha 'Yellow Queen'
 Aquilegia 'Spitfire'
 Asplenium scolopendrium 'Crispum'
 Bolton's Nobile' AGM
 Asplenium scolopendrium 'Muricatum'
 Brunnera macrophylla 'Jack Frost' AGM
 Corydalis elata x flexuosa 'Tory MP'
 Corydalis ochroleuca
 Dicentra 'King of Hearts'
 Digitalis purpurea 'Pam's Choice'
 Digitalis lutea
 Disporopsis pernyi
 Galium odoratum
 Geranium nodosum 'Whiteleaf'

Geranium renardii AGM
 Gillenia trifoliata AGM
 Iris foetidissima 'Variegata' AGM
 Lunaria rediviva
 Matthiella bupleuroides 'Green Dream'
 Omphalodes nitida
 Polemonium 'Sonia's Bluebell'
 Polygonatum x hybridum 'Striatum'
 Polystichum polyblepharum AGM
 Rhamnus alaternus 'Argenteovariegata' AGM
 Sorbus aria 'Lutescens' AGM
 Silene fimbriata
 Thermopsis rhombifolia var. montana
 Viola cornuta AGM
 Viola cornuta Alba Group AGM

AGM signifies the RHS Award of Garden Merit which is intended to be of practical value to the ordinary gardener and highlights a widely available, easy to grow, disease resistant plant.